

MICRO ARCH

A stage with an eye for visual effects.



Properties

- **4 different arch types available**
- **Span** : 4 types : 13,6; 15,6; 17,4 & 19,4 m
- **Performance area depth** : modular in steps of 4 m, typically between 8 & 16 m
- **Floor height** : adjustable between 1,40 and 2,40 m
- **Clearance** : up to 9,6 m (at the top)
- **Roof Capacity (central area)** : typically 2.500 kg per arch
- **Floor capacity** : 500 kg/m²
- **Suited for every event taking care of an attractive look** : Classical concerts, ...
- **Available with grey/black or transparent skins**
Smoothly designed, stable structure & also usable as temporary hall

MICRO ARCH

WWW.STAGECO.COM



Front view

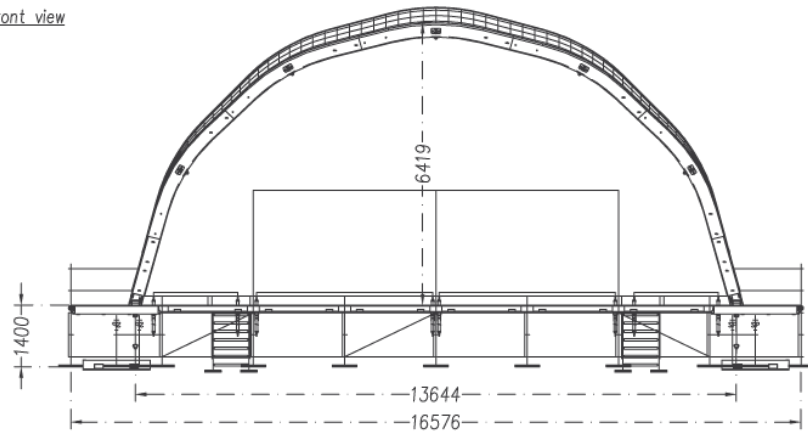

side view

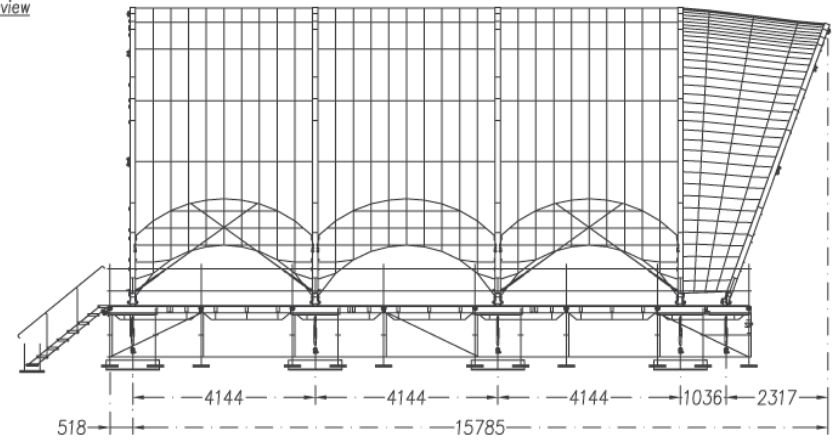

plan-view

